



skylo universal adjustable dual flush valve



WARNING

We shall not be responsible or liable for any failure of, or damage to, this plumbing product caused by the use of chlorine/bleach cleaners or related products added to the tank water. Use of such products will void the warranty and may result in product failure, possibly causing property damage. Do not over tighten plastic nuts and always turn off water supply when installing / removing toilet cistern parts.

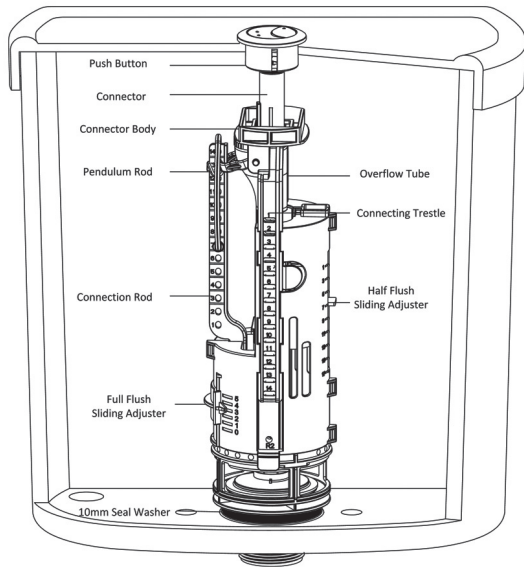

Please note: Save this instruction sheet for future reference
IMPORTANT: DO NOT use plumber's putty to seal this fitting

For more information please contact:

VIVA Sanitary

Units 1-2 Capitol Trading Park, Kirkby Bank Road
Knowsley Industrial Estate, Liverpool, L33 7SY

Tel: 0151 546 0531 Fax: 0151 549 4187

E-mail: sales@vivasanitary.co.uk

www.vivasanitary.co.uk

INSTALLATION INSTRUCTIONS

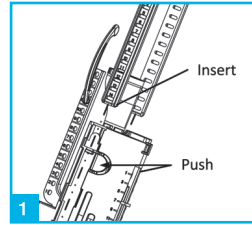

Push the two adjustment clips on the valve body simultaneously and insert the adjustment trestle into the slot. The height is adjusted by sliding the adjustment trestle up and down.

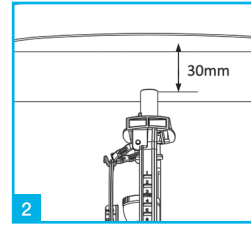

The height should be adjusted so the top of valve is 30mm below the cistern lid unless installing UNIBUTTON to fit 20mm hole were valve should be 10mm below the cistern lid.

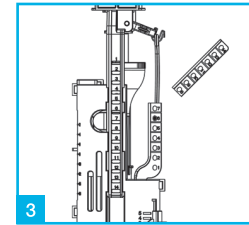

After adjusting the height of trestle, please ensure there is no obstruction to the connecting rod or pendulum rod. To remove any obstruction please cut connecting rod to suit.

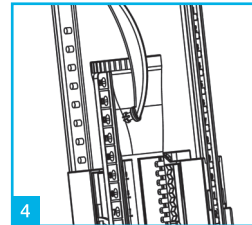

Ensure the connection rod naturally drops when the valve is in a vertical position, insert the connecting rod latch into the corresponding number on the pendulum rod.

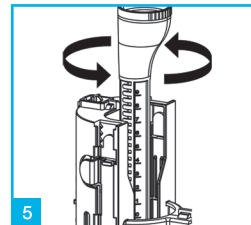

To adjust the overflow tube height, turn tube anti-clockwise and adjust up and down to the correct position. Turn clockwise to lock into place.

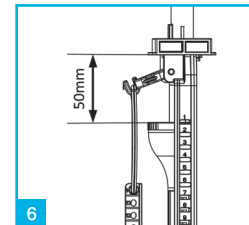

To ensure no interference with overflow tube and pendulum rod, make sure the gap in between bottom of connector body and top of overflow tube is not less than 50mm.

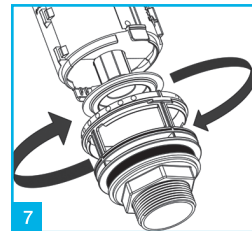

Choose the correct cradle size for the installation, 1 1/2" (factory fitted) or 2". To remove cradle twist and pull from the flush valve, to connect reverse procedure.

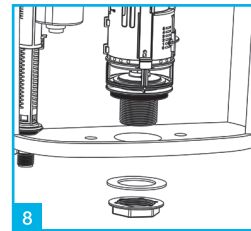

Insert the flush valve into the water tank and tighten to the tank using the washer and nut.

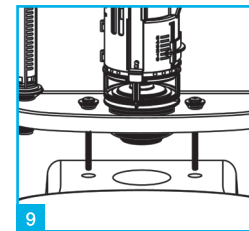

Replace or refit the doughnut washer and fasten the tank to the toilet with the bolt through kit.

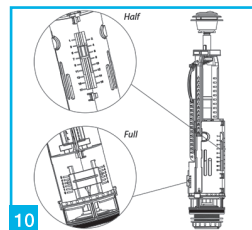

The flush volumes of both the full and half flush can be adjusted to suit your requirements. This is achieved by sliding the adjustment clips.

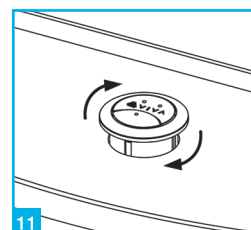

To install the button, place lid on cistern and screw button into the valve clockwise (see button guide for more information on hole sizes)

UNIBUTTON ASSEMBLY INSTRUCTIONS

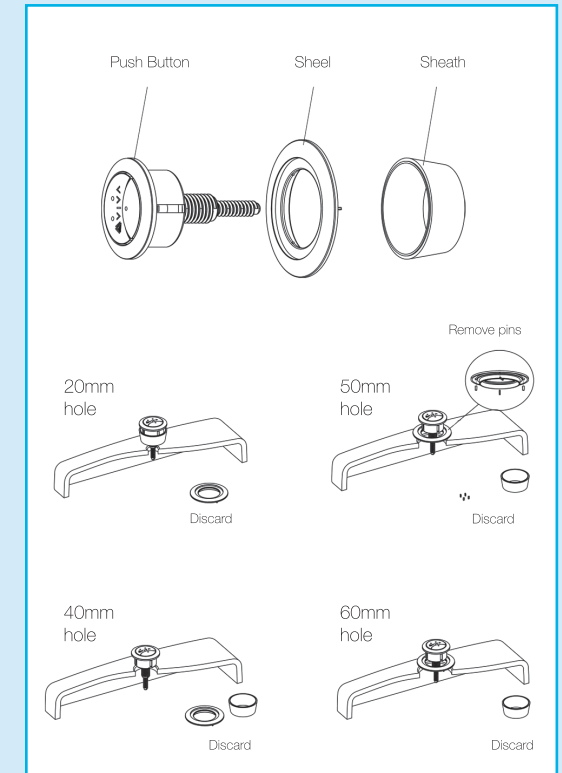

Installation videos and further information available now.

